

## SPECIFICATIONS

|               |           |               |         |
|---------------|-----------|---------------|---------|
| CAPACITY      | 100 TON   | BED WIDTH     | 1050 MM |
| WORKING RANGE | 0-1040 MM | RATED VOLTAGE | 110 V   |
| RAM STROKE    | 260 MM    |               |         |

## FEATURES

1.1. Using for mount / unmount, gears, joints, hub bearings, as well as for folding / straightening parts

## ASSEMBLY

**\*\*\*The machinery must be installed and commissioned by qualified personnel. All relevant safety regulations must be strictly adhered to! Use the disassemble drawing as your guide to assemble.**

- 2.1. When open the packing, make sure to use the proper tools, wear protective cloth, gloves, safety helmet. Make sure that the product and parts in box should be complete and identical with the part list. If not, please contact your supplier.
- 2.2. Attach one side post base to the main post and repeat for another post. Keep the frame in an upright position.
- 2.3. Insert pins into the holes of post, then put the working table onto them.
- 2.4. Attach the electrical pump onto the pump base of right post. Fill with enough hydraulic oil.
- 2.5. (Optional parts assembly if available): attach the winch to the left post, attach the adapt kits to the right post, attach the protection mesh to the working table.
- 2.6. Connect the electrical wire (no less than 2 square mm) and hose.
- 2.7. Tighten all bolts and nuts.

## BEFORE USE

- 3.1. Check all parts and conditions, if there is any part broken, stop using it and contact your supplier immediately.

**Environmental conditions:**

|                       |                                                             |
|-----------------------|-------------------------------------------------------------|
| Operating Temperature | -5℃ to +40℃                                                 |
| Storage Temperature   | -25℃ to +55℃                                                |
| Shipping Temperature  | -25℃ to +70℃ (not exceeding 24 hours)                       |
| Altitude              | Equipment should be installed at an altitude of maximum 1KM |
| Humidity              | Maximum 85% relative humidity at 40℃ non-condensing.        |
| Atmosphere            | Non-flammable, corrosive and dust free.                     |
| Ambient light         | >300LUX                                                     |
| Noise                 | Null                                                        |

## OPERATION

- 4.1 Place the arbor plate on the working table, then insert work-piece onto arbor plate.

**CAUTION! \*\*THE ARBOR PLATE MUST BE USED BY PAIR, NOT BY PIECE!**

**\*\* THE ARBOR PLATE CAN BE USED BY BOTH SIDES.**

- 4.2. Press the button to open the machine. Turn on the switch to the OIL INLET/DOWN position. the ram will extending quickly, when the ram nears to the work-piece, then turn the switch to the middle position to stop it.
- 4.3. Align work-piece and ram to ensure center loading. Adjust the protective net to a suitable height. [ if available ]
- 4.4. Turn on the switch to the OIL INLET/DOWN position to apply load onto work-piece (please see numeration in pressure gauge, Do not OVERLOAD).
- 4.5. When work is done, turn the switch to the middle position to stop it. (Remove the protective net, if available).
- 4.6. Turn on the switch to the OIL RETURN/UP position to return the ram, after ram has fully retracted,, then slowly and carefully remove the work-piece from working table.
- 4.7. Turn on the switch to the middle position. Press the button to close the machine.

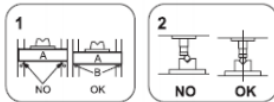

## WARNING!!

- 5.1. **DO NOT** exceed rated capacity.
- 5.2. Only use this press on a surface that is stable, level, dry and not slippery, and capable of sustaining the load.
- 5.3. **DO NOT** use it for any other purpose it is not designed to perform.
- 5.4. **DO NOT** use the shop press to compress spring or any other item that could disengage and cause a potential hazard. Never stand directly in front of loaded press and never leave loaded press unattended.
- 5.5. **DO NOT** exceed the ram stroke, so as not to damage the press.
- 5.6. **DO NOT** allow untrained persons to operate the press. **DO NOT** make any modifications to the press.
- 5.7. **DO NOT** use brake fluid or any other improper fluid and avoid mixing different types of oil when adding hydraulic oil.
- 5.8. **DO NOT** expose the press to rain or any other kind of bad weather.
- 5.9. **DO NOT** operate the press when you are tired or under the influence of alcohol, drugs or any intoxicating medication.
- 5.10. Keep children and unauthorized persons away from the work area.
- 5.11. Remove ill fitting clothing. Remove ties, watches, rings and other loose jewelry, and contain long hair
- 5.12. Keep the surface clean, tidy and free from unrelated materials and ensure that there is adequate lighting.
- 5.13. Keep hands and feet away from working table area at all times.
- 5.14. Check the press for loose or damaged parts before each operation. Replace damaged parts and tighten all bolts
- 5.15. Wear CE/ANSI approved impact safety goggles, full-face impact safety shield and heavy-duty work gloves and shoes when operating the press.

**WARNING: The warnings, cautions and instructions discussed in this instruction manual cannot cover all possible conditions and situations that may occur. It must be understood by the operator that common sense and caution are factors which cannot be built into this product, but must be supplied by the operator.**

## MAINTENANCE

- 6.1. Periodically, lubricate all moving parts including the pump piston and hydraulic ram.
- 6.2. When not in use, store the press in a dry location with ram and piston fully retracted.
- 6.3. Check hydraulic oil level and ensure all connections and hoses are well before use.
- 6.4. If the press need repairing and/or there are any parts that need to be replaced, have it repaired by authorized and trained technicians and only use the replacement parts supplied by the manufacturer.

## TROUBLE SHOOTING

| No. | Fault                                                  | Cause                                       | Remedy                                                                |
|-----|--------------------------------------------------------|---------------------------------------------|-----------------------------------------------------------------------|
| 1   | The pump is working, while the cylinder ram can't work | 1. The hose loosed<br>2. The ram is leaking | 1. Check the connecting situation of hose<br>2. Replace the oil seals |
| 2   | The cylinder ram can't fully work                      | 1. The oil is not enough                    | 1. Add oil                                                            |
| 3   | Oil leaking                                            | 1. Seals broken<br>2. Screw parts loosed    | 1. Replace the seal kits<br>2. Tighten the screw parts                |

## PARTS LIST

| No. | Description       | Qty | No. | Description      | Qty | No. | Description      | Qty |
|-----|-------------------|-----|-----|------------------|-----|-----|------------------|-----|
| 1   | Upper crossbeam   | 1   | 20  | Washer Φ12       | 12  | 39  | Bolt M12X25      | 2   |
| 2   | Cylinder          | 1   | 21  | Nut M12          | 12  | 40  | Pump base        | 1   |
| 3   | Bolt M30X100      | 8   | 22  | Post support     | 4   | 41  | Bolt M12X25      | 4   |
| 4   | Washer Φ30        | 8   | 23  | Bolt M12X25      | 12  | 42  | Clip             | 1   |
| 5   | Spring washer Φ30 | 8   | 24  | Post base left   | 1   | 43  | Bolt M6X30       | 1   |
| 6   | Nut M30           | 8   | 25  | Bolt M12X40      | 8   | 44  | Spring washer Φ6 | 3   |
| 7   | Left post         | 1   | 26  | Washer Φ12       | 8   | 45  | Bolt M6X12       | 2   |
| 8   | Pin               | 4   | 27  | Nut M12          | 8   | 46  | Hose             | 2   |
| 9   | Wheel             | 2   | 28  | Bottom crossbeam | 2   | 47  | Pump             | 1   |
| 10  | R-pin             | 4   | 29  | Switch           | 1   | 48  | Working table    | 1   |

|    |             |   |     |                   |   |     |              |   |
|----|-------------|---|-----|-------------------|---|-----|--------------|---|
| 11 | Bolt M10X30 | 3 | 30  | Wheel             | 2 | 49  | Clip         | 4 |
| 12 | Winch       | 1 | 31  | Handle            | 1 | 50  | Arbor plate  | 2 |
| 13 | Washer Ø10  | 3 | 32  | Right post        | 1 | 51  | Spring       | 4 |
| 14 | Nut M10     | 3 | 33  | Post base right   | 1 | 52  | Bolt         | 3 |
| 15 | Winch base  | 1 | 34  | Spring washer Ø12 | 4 | 53  | Nut M12      | 3 |
| 16 | Bolt M10X30 | 4 | 35  | Nut M12           | 4 | 54  | Square shaft | 2 |
| 17 | Washer Ø10  | 4 | 36  | Support           | 2 | 55  | Wheel        | 4 |
| 18 | Nut M10     | 4 | 37  | Spring washer Ø12 | 2 | 56  | Ring 20      | 4 |
| 19 | Pin         | 2 | 38  | Nut M12           | 2 | 57  | Bolt         | 1 |
| A1 | handle      | 1 | A6  | mesh              | 1 | A11 | wheel        | 4 |
| A2 | bolt M6X20  | 2 | A7  | bush              | 4 | A12 | shaft sleeve | 4 |
| A3 | washer Ø10  | 2 | A8  | bolt M10x50       | 4 | A13 | bolt M10X35  | 4 |
| A4 | nut M6      | 2 | A9  | Hand wheel        | 2 |     |              |   |
| A5 | frame       | 1 | A10 | mounting plate    | 2 |     |              |   |
| B1 | 0.5" Ram    | 1 | B5  | 2" Ram            | 1 | B9  | Plate        | 1 |
| B2 | 0.75" Ram   | 1 | B6  | Ram connector     | 1 | B10 | Bolt M10X25  | 2 |
| B3 | 1" Ram      | 1 | B7  | Bolt M8x20        | 1 | B11 | Washer Ø10   | 2 |
| B4 | 1.5" Ram    | 1 | B8  | Ram base          | 1 | B12 | Nut M10      | 2 |

#### DISASSEMBLE DRAWING

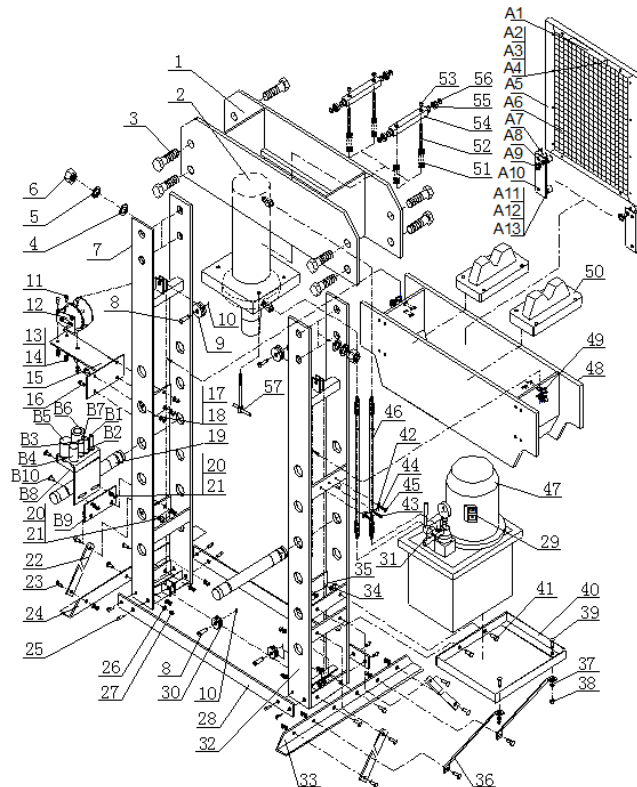

# 100 TON SHOP PRESS

## (Electric) INSTRUCTION MANUAL



**\*\*\*IMPORTANT: PLEASE READ THIS INSTRUCTION MANUAL CAREFULLY BEFORE USE.  
NOTE THE SAFETY INSTRUCTIONS & WARNINGS.  
USE THE PRODUCT CORRECTLY AND WITH CARE FOR THE PURPOSE  
FOR WHICH IT IS INTENDED.  
RETAIN THIS MANUAL FOR FUTURE REFERENCE**