

MOTORCYCLE DOLLY

1250LBS

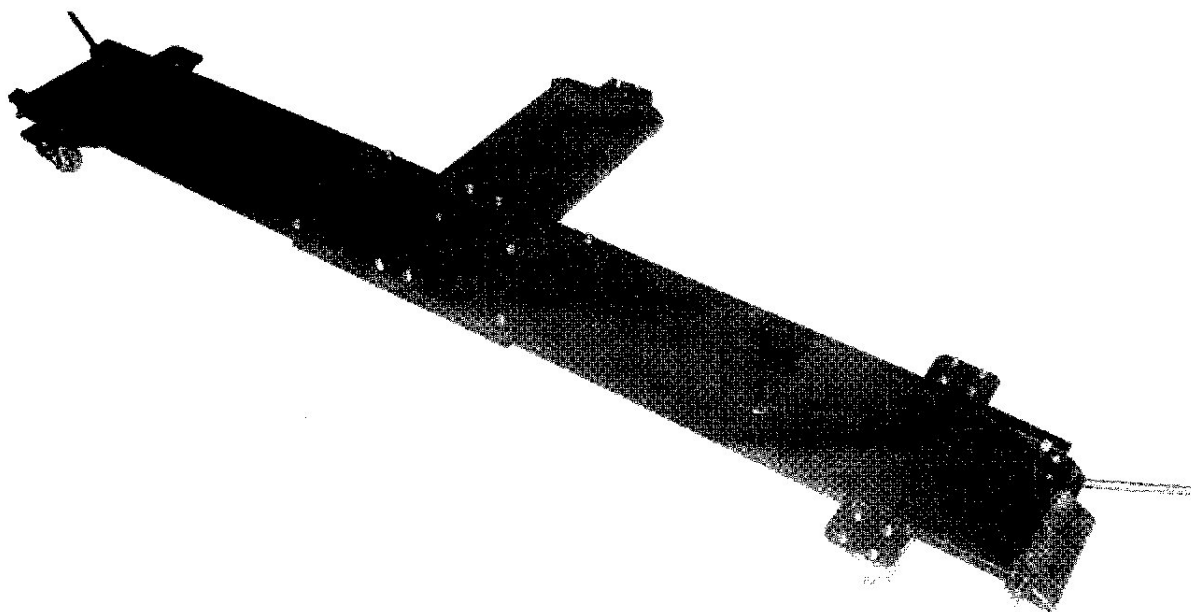

Instruction Manual

Please read this instruction manual carefully before use.

IMPORTANT

PLEASE READ THESE INSTRUCTIONS CAREFULLY. NOTE THE SAFETY INSTRUCTIONS AND WARNINGS. USE THE PRODUCT CORRECTLY AND WITH CARE FOR THE PURPOSE FOR WHICH IS INTENDED. FAILURE TO DO SO MAY CAUSE DAMAGE TO PROPERTY AND/OR PERSONAL INJURY. PLEASE KEEP THIS INSTRUCTION MANUAL SAFE FOR FUTURE USE.

1. SAFETY INSTRUCTIONS AND WARNINGS

- 1.1 Use a qualified person to maintain the dolly in good condition. Keep it clean for best and safest performance.
- 1.2 The maximum load is 1250 Lbs. DO NOT exceed this rated capacity.
- 1.3 Use this dolly for carrying motorcycle purpose only. DO NOT use it for any other purpose it is not designed to perform.
- 1.4 Do not use the dolly in carrying or moving person, and DO NOT sit on the dolly.
- 1.5 Keep children and unauthorized persons away from the work area.
- 1.6 Remove loose clothing. Remove ties, watches, rings and other loose jewelry, and contain long hair.
- 1.7 Wear ANSI approved safety goggles when operating the dolly.
- 1.8 Keep proper balance and footing, do not overreach and wear nonskid footwear.
- 1.9 Only use the dolly on a surface that is stable, level, dry and not slippery, and capable of sustaining the load.
- 1.10 Put the handles on Carriage A and Carriage B down when not in use, lock it in a safe, dry place and keep away from children.
- 1.11 Always keep your hands and feet away from moving parts.
- 1.12 **DO NOT** operate the dolly when you are tired or under the influence of alcohol, drugs or any intoxicating medication.
- 1.13 **DO NOT** make any modifications to the dolly..
- 1.14 **DO NOT** expose the table to rain or snow.
- 1.15 If the dolly needs repairing and/or there is any part which needs to be replaced, have it repaired by authorized technicians and only use the replacement parts supplied by the manufacturer.

WARNING: the warnings, cautions and instructions discussed in this instruction manual cannot cover all possible conditions and situations that may occur. It must be understood by the operator that common sense and caution are factors which cannot be built into this product, but must be supplied by the operator.

2. ASSEMBLY

Unpack the table and check contents with list below. Should there be any damaged or missing parts, contact your supplier immediately.

Content

Caster Ass'y	Side tray
Frame Ass'y	Carriage A, Carriage B
Step pin, Connecting plate	Bolt, Nut, Washer, Lock washer
Connecting pipe	

2.1 Assembly Caster ass'y

Attach five Caster ass'y to Frame ass'y (1) and Side tray (17) by using Hex Bolt M6x16 (3), Washer (4), Lock washer (5) and Nut (6). Secure them firmly.

2.2 Assembly Carriage A and Carriage B

Fit Connecting plate (7) to the two sides of Carriage A (9), then attach the Connecting plate (7) to Frame ass'y (1) by using Cheese head blot (8), Washer (4), Lock washer (5) and Nut (6) firmly. The way of assembling Carriage B is the same as Carriage A as described.

2.3 Associate Frame ass'y

Connect two Frame ass'y (1) by two Connecting pipes (16), then fix them by using Bolt (11), Washer (12), Lock washer (13) and Nut (14).

2.4 Assembly Side tray

Fit Side tray (17) to Frame ass'y (1) by using Bolt (15), Washer (12), Lock washer (13) and Nut (14) tightly.2.5 Attach two Stop pins (10) to the slots on each end of Frame ass'y (1), screw all nuts tightly. Thus the Motorcycle dolly has been accomplished.

3. OPERATION

3.1 When in use, please put the handles on Carriage A (9) and Carriage B (18) down to lock the dolly. Thus it is easy to push the motorcycle up.

3.2 Take the Stop pin (10) off at one side, push the motorcycle up to the dolly and support the motorcycle by its side foot on the Side tray (7), then put the Stop pin (10) back.

3.3 Fasten motorcycle to the dolly by using belts to prevent the motorcycle toppling over during transmission.

3.4 Pull back the handles on Carriage A (9) and Carriage B (18), the dolly can move again.

4. MAINTENANCE

4.1 Check all the nuts if they are firmly screwed.

4.2 Periodically check all the joints. Remove from service if any cracking or the frame is bent or deformed.

4.3 Lubricate wheels periodically for best use.

4.4 Put the handles on Carriage A and Carriage B down when not in use to lock the wheels.

MOTORCYCLE DOLLY

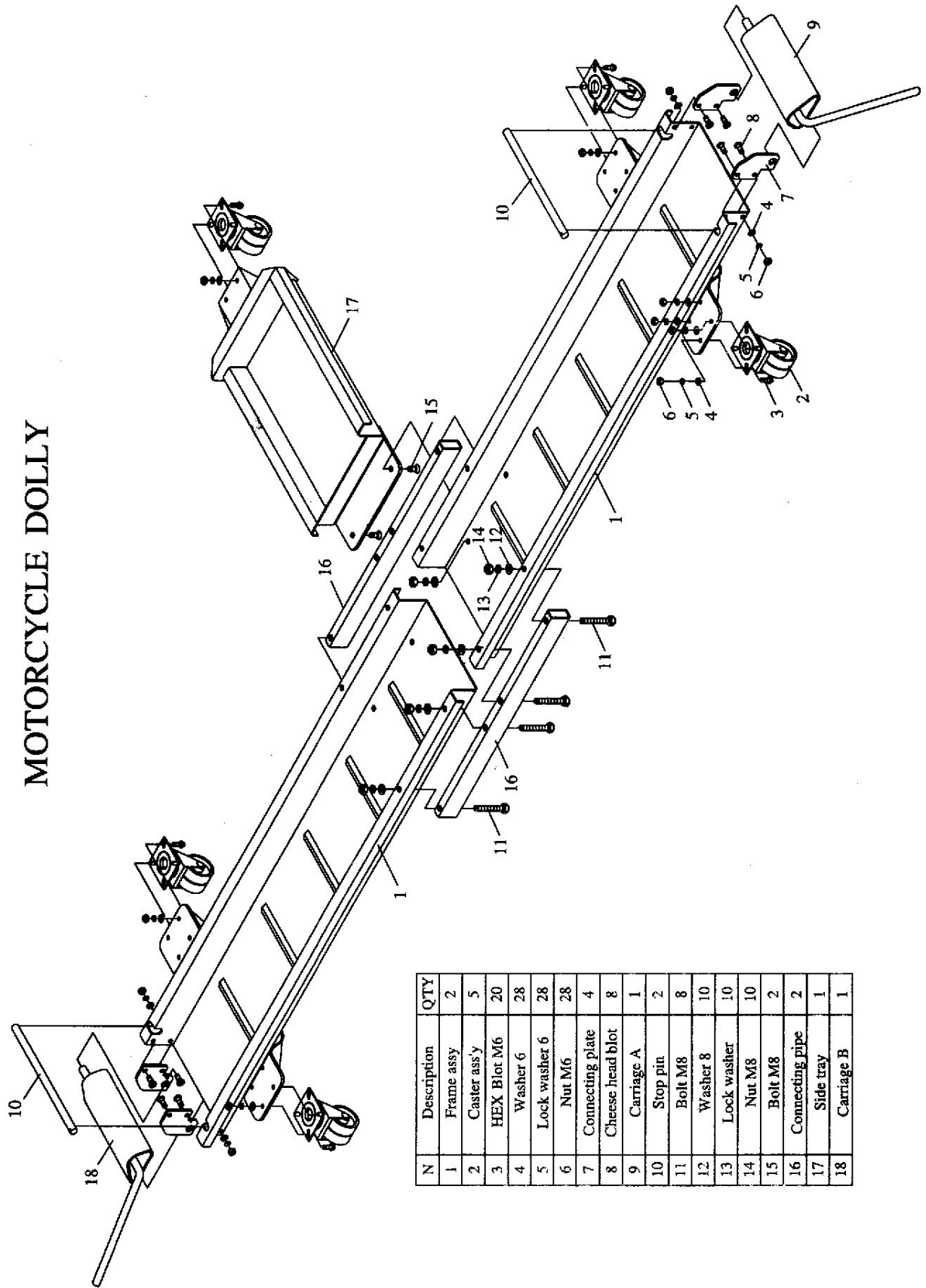

N	Description	QTY
1	Frame assy	2
2	Caster ass'y	5
3	HEX Bolt M6	20
4	Washer 6	28
5	Lock washer 6	28
6	Nut M6	28
7	Connecting plate	4
8	Cheese head blot	8
9	Carriage A	1
10	Stop pin	2
11	Bolt M8	8
12	Washer 8	10
13	Lock washer	10
14	Nut M8	10
15	Bolt M8	2
16	Connecting pipe	2
17	Side tray	1
18	Carriage B	1