

SPECIFICATIONS

CAPACITY	1500 LBS	MAX HEIGHT	400 MM
MIN HEIGHT	120 MM		

FEATURES

1.1. Used for motorcycle lifting.

ASSEMBLY

****The machinery must be installed and commissioned by qualified personnel. All relevant safety regulations must be strictly adhered to! Use the disassemble drawing as your guide to assemble.**

- 2.1. Attach the bottle Jack to the jack mounting Plate.
- 2.2. Pump the jack into the proper position and secure the piston with the lifting frame
- 2.3. Attach safety bar and safety bar handle to the lifting frame.
- 2.4. Attach foot pedal and handle.
- 2.5. Tighten all bolts and nuts.

BEFORE USE

- 3.1. Purge air away from hydraulic system
- 3.1.1 **Manual operating system:** Let the lift in the lowest position, fully press the release foot pedal, then quickly press lifting foot pedal 10-20 times to eliminate any air in the hydraulic system.
- 3.2. Carefully and slowly pinch oil fill plug to release trapped air.
- 3.3. Position the lift in a suitable area, checking that the surface on which the lift will stand is solid and flat.

OPERATION

TO RAISE THE VEHICLE

- 4.1. To avoid item from slipping during the raising operation, ONLY lift on points of vehicle specified by vehicle manufacturer in the vehicle’s operator’s manual.
- 4.2. Place the lift under the vehicle so that the Lift Saddle is positioned under the vehicle’s lift point.
- 4.3. Pump the lifting foot pedal until the lift saddle comes in contact with the vehicle to be lifted, always check to be sure that the saddle and the vehicle are positioned correctly **BEFORE** raising the jack.
- 4.4. Apply tie-down Straps (sold separately) BEFORE lifting the motorcycle. Thoroughly tighten the two tie-down straps.
- 4.5. Pump lifting foot pedal to raise vehicle until tip of safety bar moves past desired lock position ridge. The tip of the safety bar will sink into position just behind the ridge. Depress release pedal slightly so that the tip moves snugly against ridge.
- 4.6. Once vehicle has been raised to the desired working height, then locking safety support.

TO LOWER THE VEHICLE

- 4.7. Raise the lift slightly and pull back on the safety bar handle to release safety bar.
- 4.8. Pull the safety bar handle to release the safety lock.
- 4.9. Press the release pedal very gently to lower the saddle and vehicle.
- 4.10. Remove tie-down, then vehicle.

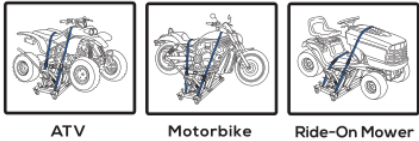

WARNING!!

- 5.1. **DO NOT** exceed rated capacity.
- 5.2. When the lift saddle is at its highest position, **DO NOT** attempt to pump the lift higher as this can damage the mechanism.
- 5.3. **Use this lift for lifting purpose only.** DO NOT use it for any other purpose it is not designed to perform.
- 5.4. Keep children and unauthorized persons away from the work area.

- 5.5. Remove all loose fitting clothing. Remove ties, watches, rings and other loose jewelry, and contain long hair.
- 5.6. Wear ANSI/CE approved safety goggles when operating the lift.
- 5.7. Only use this lift on a surface that is stable, level, dry and not slippery, and capable of sustaining the load. Keep the surface clean, tidy and free from unrelated materials and ensure that there is adequate lighting.
- 5.8. Always center load on lift saddle. When the lift saddle has been raised to the working height, ensure the locking bar is engaged to prevent accidental lowering.
- 5.9. Always keep your hands and feet away from moving parts.
- 5.10. **DO NOT** attempt to transport a load on the lift. The lift must only be used in a static position for lifting and lowering loads. Ensure that the load remains stable at all times.
- 5.11. **DO NOT** operate the lift when you are tired or under the influence of alcohol, drugs or any intoxicating medication.
- 5.12. **DO NOT** allow untrained persons to operate the lift.
- 5.13. **DO NOT** make any modifications to the lift.
- 5.14. **DO NOT** expose the lift to rain or any other kind of bad weather.

WARNING: The warnings, cautions and instructions discussed in this instruction manual cannot cover all possible conditions and situations that may occur. It must be understood by the operator that common sense and caution are factors which cannot be built into this product, but must be supplied by the operator.

MAINTENANCE

- 6.1. Keep the lift clean and wipe off any oil or grease. Lubricate all moving parts.
- 6.2. When not in use, the lift must be stored in the lowest position in a dry location to minimize ram and piston corrosion.
- 6.3. Before each use check all parts, ensure that all applicable bolts and nuts are firmly tightened. If any part of the lift is damaged or suspect, remove the lift from service and take necessary action to repair
- 6.4. Periodically check the ram and piston for signs of corrosion. Clean exposed areas with a clean oiled cloth
- 6.5. When lift efficiency drops, purge away air from the hydraulic system.
- 6.6. Check the hydraulic oil level. If not adequate, add hydraulic oil as necessary. **DO NOT** use brake fluid or any other improper fluid.
- 6.7. If the lift need repairing and/or there are any parts that need to be replaced, have it repaired by authorized and trained technicians and only use the replacement parts supplied by the manufacturer.

TROUBLE SHOOTING

No.	Fault	Cause	Remedy
1	Can't lift load	1. Overload 2. Release valve not complete closed 3. Air in hydraulic system	1. Remove partial overload 2. Check the release valve 3. Purge air away, see BEFORE USE , 3.1
2	Can't lift to full height	1. The oil is not enough 2. Air in hydraulic system	1. Add oil 2. Purge air away, see BEFORE USE , 3.1
3	Oil leaking	1. Seals broken 2. Screw parts loosed	1. Replace the seal kits 2. Tighten the screw parts

PARTS LIST

No.	Description	Qty	No.	Description	Qty	No.	Description	Qty
1	Saddle	1	14	Foot pedal	1	27	Nut M12	2
2	Pin	4	15	Pin	1	28	Spring washer Ø12	2
3	Washer Ø12	10	16	Pin	1	29	Universal wheel	2
4	R-pin	10	17	Rubber sheet	1	30	Support screw	2
5	Safety handle	1	18	Spring	1	31	Pin	2
6	Rear lifting arm	1	19	Bolt M6X20	1	32	Base	1
7	Safety support	1	20	Bolt M8X12	1	33	Pin	4
8	Bolt M12X100	2	21	Bolt M8X20	2	34	Straight wheel	2

9	Pump	1	22	Lock nut M6	2	35	Front lifting arm	1
10	Washer Ø8	2	23	Washer Ø6	2	36	Handle	1
11	Nut M8	2	24	Clip	1	37	Handle sleeve	1
12	Lifting frame	1	25	Bolt M6X16	2			
13	Bolt M8X35	1	26	Lock nut M12	2			

DISASSEMBLE DRAWING

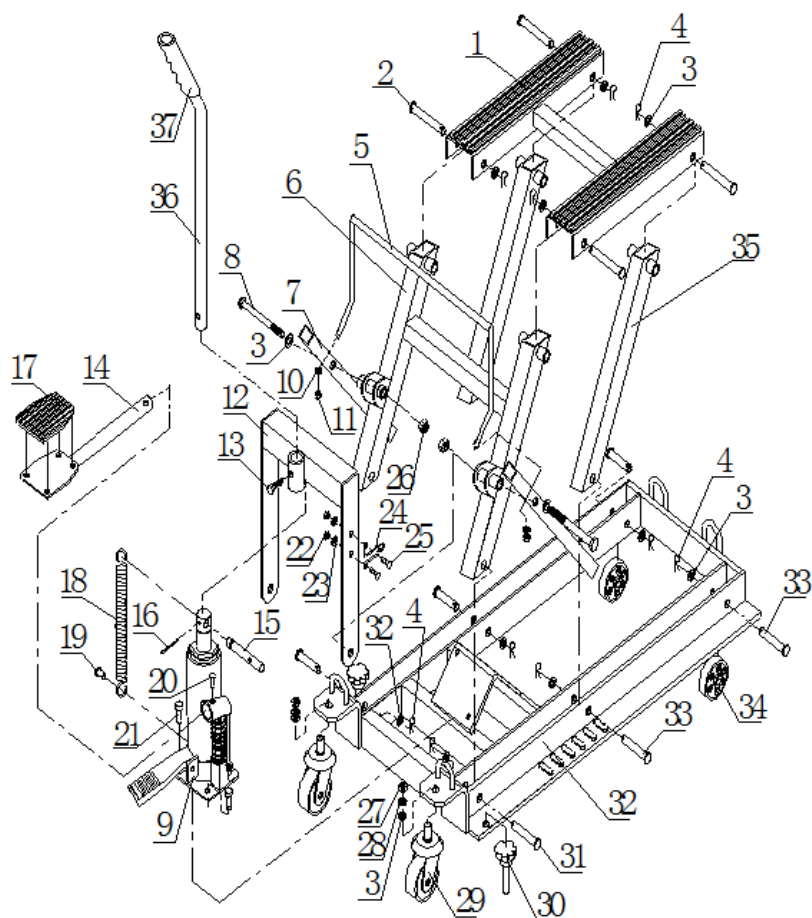

1500LB MOTORCYCLE LIFT

(Hydraulic) INSTRUCTION MANUAL



*****IMPORTANT: PLEASE READ THIS INSTRUCTION MANUAL CAREFULLY BEFORE USE.
NOTE THE SAFETY INSTRUCTIONS & WARNINGS.
USE THE PRODUCT CORRECTLY AND WITH CARE FOR THE PURPOSE
FOR WHICH IT IS INTENDED.
RETAIN THIS MANUAL FOR FUTURE REFERENCE**