



## **WARNING**



The warnings, precautions and instructions in this manual cannot cover all possible conditions and situations that may occur. The operator must understand that the operator must supply common sense and examine caution factors when using this product to determine safety in all circumstances being used.



**TITAN MARKETING, LLC**

PO Box 7069 Greenwood, IN 46142  
1.888.908.4826 FAX (317) 215.2770  
[www.titanlifts.com](http://www.titanlifts.com)

**Patent No.: US 8,104,588 B2**  
**CA 2,729,670**

Copyright © 2017 by Titan Marketing, LLC. All rights reserved. No portion of this manual or any artwork contained herein may be reproduced in any shape or form without the express consent of Titan Marketing, LLC. Diagrams within this manual may not be drawn proportionally. Due to continuing improvements, actual product may differ slightly from the product described herein. Tools required for assembly and service may not be included.



## **AUTOMOTIVE ROTISSERIE MANUAL**



## **MODEL: ROT-4500** **4,500 LB ROTISSERIE**



**FOLLOW THIS MANUAL CAREFULLY TO ENSURE THE EQUIPMENT WILL FUNCTION CORRECTLY AND PROVIDE MANY YEARS OF DEPENDABLE SERVICE. FAILURE TO FOLLOW THESE INSTRUCTIONS AND SAFETY WARNINGS MAY RESULT IN PERSONAL INJURY OR PROPERTY DAMAGE. KEEP THIS MANUAL IN A SAFE DRY PLACE FOR FUTURE REFERENCE.**

## DESCRIPTION

This product should be used for repairing and maintaining automobiles. The vehicle can be lifted 49" and rotated 360°.

## SAFETY

1. DO NOT exceed the rated capacity of the equipment
2. Stay clear of the equipment when lifting or lowering
3. Keep the area around the equipment clear of obstacles
4. ALWAYS use the safety lock on the equipment

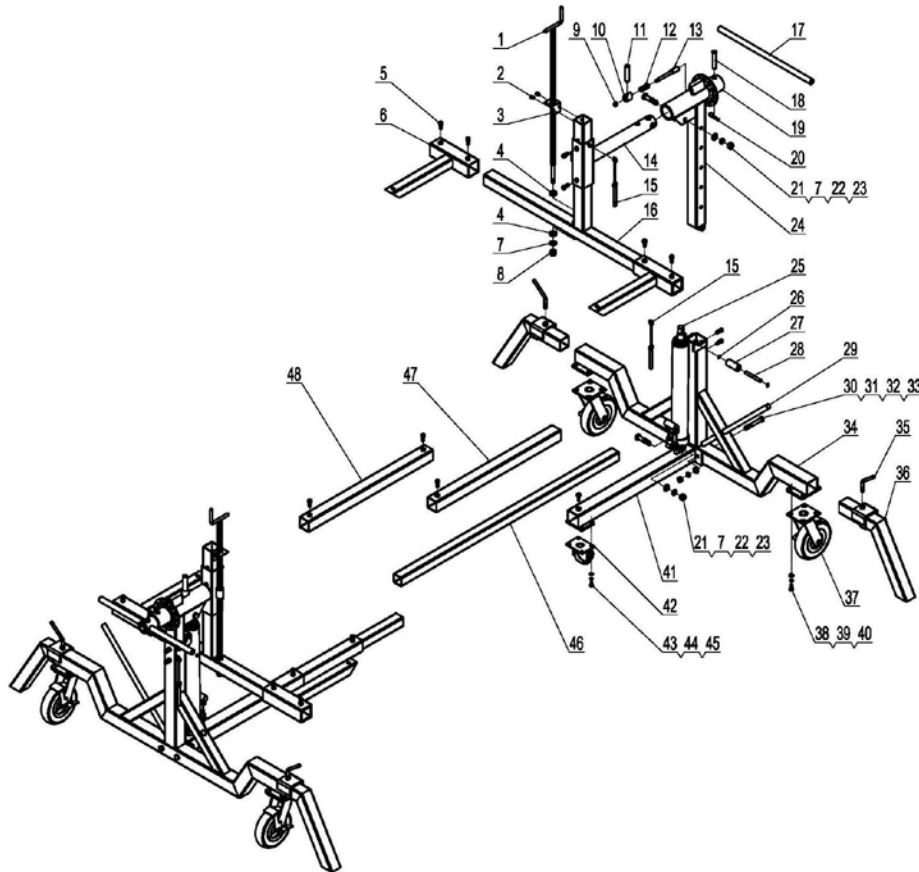

## SPECIFICATIONS

Max Height: 49"

Min Height: 21"

Max Length: 260"

Min Length: 121"

Width: 81"

Max Length Between Support Arms: 238"

Min Length Between Support Arms: 99"

N0.	Description	QTY	N0.	Description	QTY
1	Adjust Screw Rod	2	25	Hydraulic Cylinder	2
2	Screw M8*12	4	26	Circlip	4
3	Screw Rod Stand	2	27	Guide Sleeve	2
4	Bearing	4	28	Guide Spindle	2
5	Screw M10*25	22	29	Operation Handle	2
6	Movable Stand	4	30	Bolt M14*100	4
7	Flat Washer Φ16	6	31	Flat Washer Φ14	4
8	Lock Nut M16	2	32	Lock Washer Φ14	4
9	Lock Nut M10	2	33	Lock Nut M14	4
10	Wedge Handle Seat	2	34	Main Stand	2
11	Handle	2	35	Set Screw	4
12	Spring	2	36	Steel Feet	4
13	Locking Pin	2	37	8" Caster	4
14	Rotating Stand	2	38	Bolt M10*20	16
15	Chain Pin	4	39	Lock Washer Φ10	16
16	Stand	2	40	Flat Washer Φ10	16
17	Turning Handle	2	41	Main Connecting Rod	2
18	Connecting Pin	2	42	3" Caster	2
19	Locking Plate	2	43	Bolt M8*16	8
20	R-pin	2	44	Lock Washer Φ8	8
21	Bolt M16*70	4	45	Flat Washer Φ8	8
22	Lock Washer Φ16	4	46	Extending Rod	2
23	Nut M16	4	47	Connecting Rod	2
24	Lifting Stand	2	48	Intermediate Connecting Rod	1