

STEP 1. Install the 5"caster w/brake (#21 -1pcs) and 5" Casters (#23 -2pcs) onto one of the Base (#18) pieces with Washer (#19) and Bolt M8x14(#20).

STEP 2. Install Rack Column (#12) onto the Base (#18) with BoltM16x11 0(#17), Washer16 (#2), Washer 16(#14), and NutM16(#1).

STEP 3. Install Column Support(#15 -2pcs) onto Base(#18) with BoltM16x110(#17), Washer16(#2), Washer16(#14), NutM16 (#1), then connect the Column Support(#15 -2pcs) to the Rack Column(#12) with BoltM16x120(#16), Washer16(#2), Washer16(#14), and NutM16(#1).
(Repeat STEP 1-3 for the other side)

STEP 4. Use Bolt M 12x35(#3 -4pcs), Washer 12(#7 -4pcs), and Nut M 12(#8 -4pcs) to connect Hand Crank (#4) and Master Pivot Attachment (#32) onto Mounting Arm 1 (#10) and tighten securely.

STEP 5. Once the Mounting Arm1(#10), Hand Crank(#4), and Master Pivot Attachment(#32) have been assembled, attach them to the Rack Column(#12) use BoltM27x125 (#9), Washer(#6) and NutM27(#5).

STEP 6. Install one of the Hydraulic Jack (#13) onto Base (#18) with Bolt M16x90 (#22), Washer 16(#2), NutM16 (#1). The handle of the piston of the Hydraulic Jack (#13) can be adjusted to fit onto Hand Crank (#4) with Bolt M 16x65(#11), Washer16 (#2), and NutM16 (#1).

STEP 7. Use Bolt M 27x125(#9), Washer (#6), NutM27 (#5) to Connect T-arm (#29) and Slave Pivot Attachment (#32).
(choose the hole that will allow the vehicle to set at your preferred height)

STEP 8. Mounting Arm2 (#30) and Slave Pivot Attachment (#31) should be installed onto the other Rack Column (#12), with BoltM27x125(#9), Washer27(#6), NutM27(#5).
(height needs to be same with STEP 5)

STEP 9. Use BoltM16x90(#22), Washer16(#2), NutM16(#1) to attach the second Hydraulic Jack(#13) onto Base(#18); use BoltM16x65(#11), Washer(#2), NutM16(#1) to fix the handle of piston of Hyd. jack(#13) onto Mounting Arm2(#30).

STEP 10. Connect the T-Arm (#29) to Slave Pivot Attachment (#31) with BoltM27x125 (#9), Washer27 (#6), NutM27 (#5).

STEP 11. Adjust the width between Adapter Arms (#27) and T-arm (#29) and secure evenly with BoltM20x50 (#28).

STEP 12. Place the two Extension Tubes(#24) into both Bases(#18) and use the Connection Tube(#26) to connect both the Extension Tubes(#24) together with BoltM12x50 (#25).

STEP 13. Finally the base of Vehicle can be loaded on. Use Hand Crank handle to control its angle until turned to the correct position. Use BoltM20x50 (28) to attach Slave Pivot Attachment (#31) with Mounting arm 2(#30).

STEP 14. Make sure all nuts and bolts are securely tightened before using the rotisserie.

STEP 15. Some related bolts may need to be loosened when you adjust height, length, width or angle of the car's position.

STEP 16.

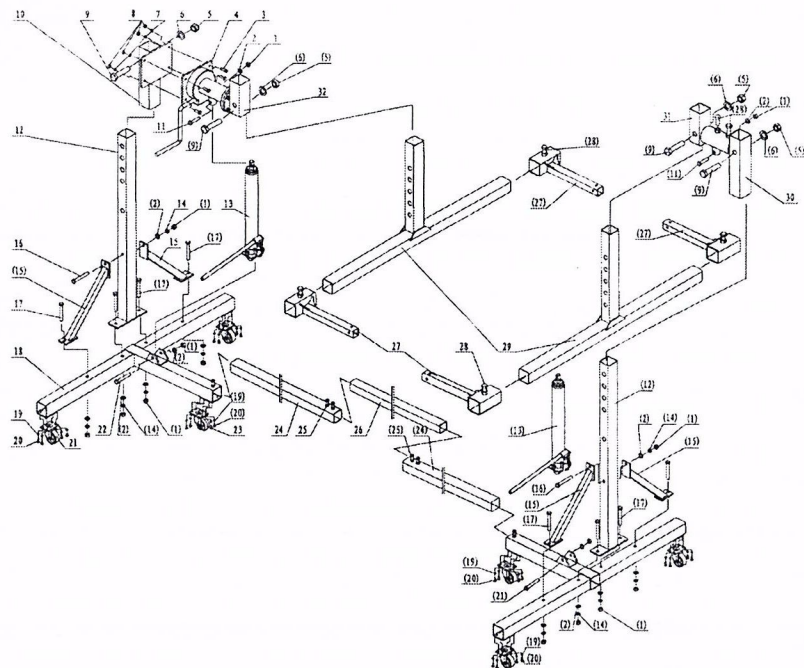

No.	Description	Qty.	No.	Description	Qty.
1	NutM16	14	17	BoltM16x110	8
2	Washer16	14	18	Base	2
3	BoltM13x35	4	19	Washer8	24
4	Hand Crank	1	20	BoltM8x14	24
5	NutM27	4	21	5" Caster w/brake	2
6	Washer27	4	22	BoltM16x90	2
7	Washer12	4	23	5" Caster	4
8	NutM12	4	24	Extension Tube	2
9	BoltM27x125	4	25	BoltM12x50	6
10	Mounting Arm1	1	26	Connection Tube	1
11	BoltM16x65	1	27	Adapter Arms	4
12	Rack Column	2	28	BoltM20x50	6
13	Hydraulic Jack	2	29	T-Arm	2
14	Washer16	10	30	Mounting Arm2	1
15	Column Support	4	31	Slave Pivot Attachment	1
16	BoltM16x120	2	32	Master Pivot Attachment	1

SPINS ROTISSERIE SETUP GUIDE

