

# OPERATOR'S MANUAL

POWER TRAIN LIFT  
(750 KG Max. Capacity)



**⚠** Read this manual and follow all the safety rules and operating instructions before using this product.

## 1. WARNING!

- Study, understand, and follow all instructions before operating this device.
- No alterations shall be made to this product
- Before using the lift, inspect the unit for leaks, or damaged, loose, or missing parts. Immediately replace cut, frayed, damaged hoses, and electrical cords.
- Only use attachments and/or adapters supplied by the manufacturer.
- Adequately support the vehicle before starting repairs.
- Securely tighten the strap assembly around the component being lifted.
- Do not exceed the rated capacity.
- Do not lift or move a load that has a center of gravity extending beyond the wheels. Tipping can result in personal injury.
- Do not move the lift while the load is raised. Always lower the load completely before moving or storing the load.
- Carefully and slowly move a load on an incline or around a corner. Tipping can result in personal injury.
- Use only on a hard, level surface.
- Do not stand under a load that is supported by the lift.
- The component must be securely held in place before it is removed from the lift.

## 2. SETUP

- Refer to the exploded view parts drawing for identification, location and position of parts.
- Read the air hydraulic pump operate manual to understand how to operate the air hydraulic pump.
- Install the air quick disconnect of your choice at the rear of the hydraulic foot pump and connect the shop airline.
- The power train lift table is equipped with a universal saddle.

## 3. OPERATING INSTRUCTIONS

### 3.1 REMOVAL

- Follow the vehicle manufacturer's recommended service procedure for removal of the component.
- Position the power train lift under the vehicle. Connect the air hydraulic pump to the air source.
- Press pedal of the air hydraulic pump to raise the lift to the load.
- Adjust the wood blocks to fit the assembly.
- Turn the adjusting screws to align the lift with the component. Raise the lift to the correct position.
- Remove any remaining bolts from the vehicle component.
- Completely lower the power train lift by pressing the release pedal of the air hydraulic pump.
- Move the lift and load out from under the vehicle.

### 3.2 INSTALLATION

- Position the power train lift under the chassis.
- Raise the power train lift and turn the adjusting screws to align the component in the correct position.
- Follow the vehicle manufacturer's recommended service procedure for installing the component.

## 4. MAINTENANCE

- Always store the lift table in a well-protected area where it will not be exposed to inclement weather, corrosive vapors, abrasive dust, or any other harmful elements. The lift table must be cleaned of water, snow, sand, or grit before using.
- Use a good grade lubricant to regularly lubricate the pivot points, the adjusting screws, and the swivel casters.

# 5. PART LIST

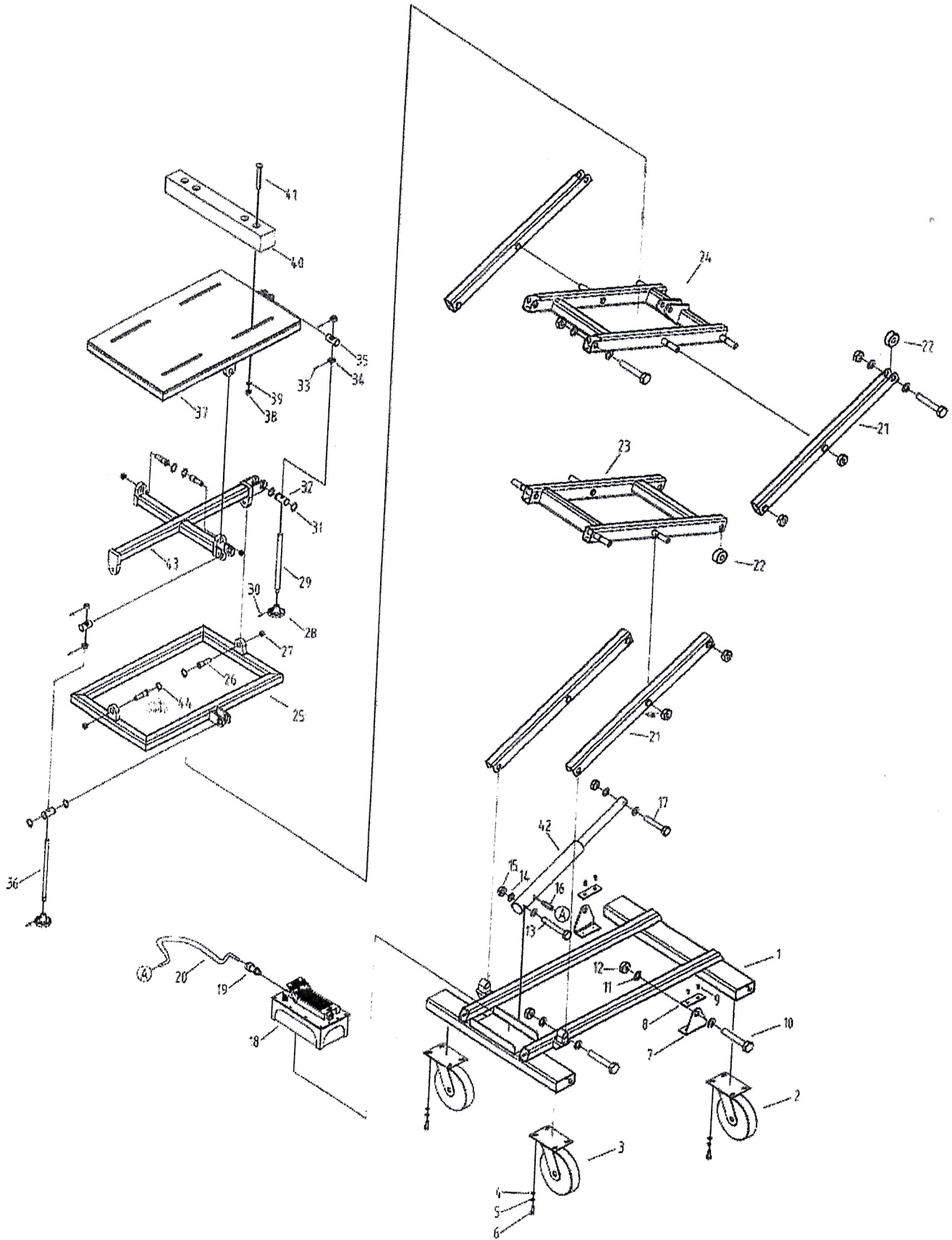



NO.	Description	Qty			
1	Base Assembly	1	23	Lift Seat B	1
2	Caster	2	24	Lift Seat A	1
3	Caster with locker	2	25	Saddle Base	1
4	Washer	16	26	Axle	4
5	Washer	16	27	Lock Nut	4
6	Bolt	16	28	Hand Wheel	2
7	Plate	2	29	Screw A	1
8	Anti-wear Block	2	30	Pin	2
9	Bolt	4	31	Snap Ring	4
10	Bolt	8	32	Axle	2
11	Washer	16	33	Pin	4
12	Lock Nut	16	34	Bush	4
13	Bolt	1	35	Shaft	2
14	Washer	4	36	Screw B	1
15	Lock Nut	2	37	Saddle	1
16	Flow Valve Block	1	38	Flange Nut	4
17	Bolt	1	39	Washer	4
18	Hydraulic pump	1	40	Square Wooden bar	2
19	Coupler	1	41	Bolt	4
20	Hose	1	42	Cylinder	1
21	Pillar	4	43	Support Plate	1
22	Movable Pulley	4	44	Snap Ring	4